

NOTE
 This drawing is not to be scaled. All dimensions to be checked on site and any discrepancies to be reported to the Mouchel office. All material is produced on behalf of Mouchel Ltd. All drawings to be read in conjunction with specification where applicable.
 © MOUCHEL Ltd.
 Based upon the Ordnance Survey map with the permission of the Controller of Her Majesty's Stationery Office © Crown Copyright Licence No. LA07649X.

Gross internal Area 174m²

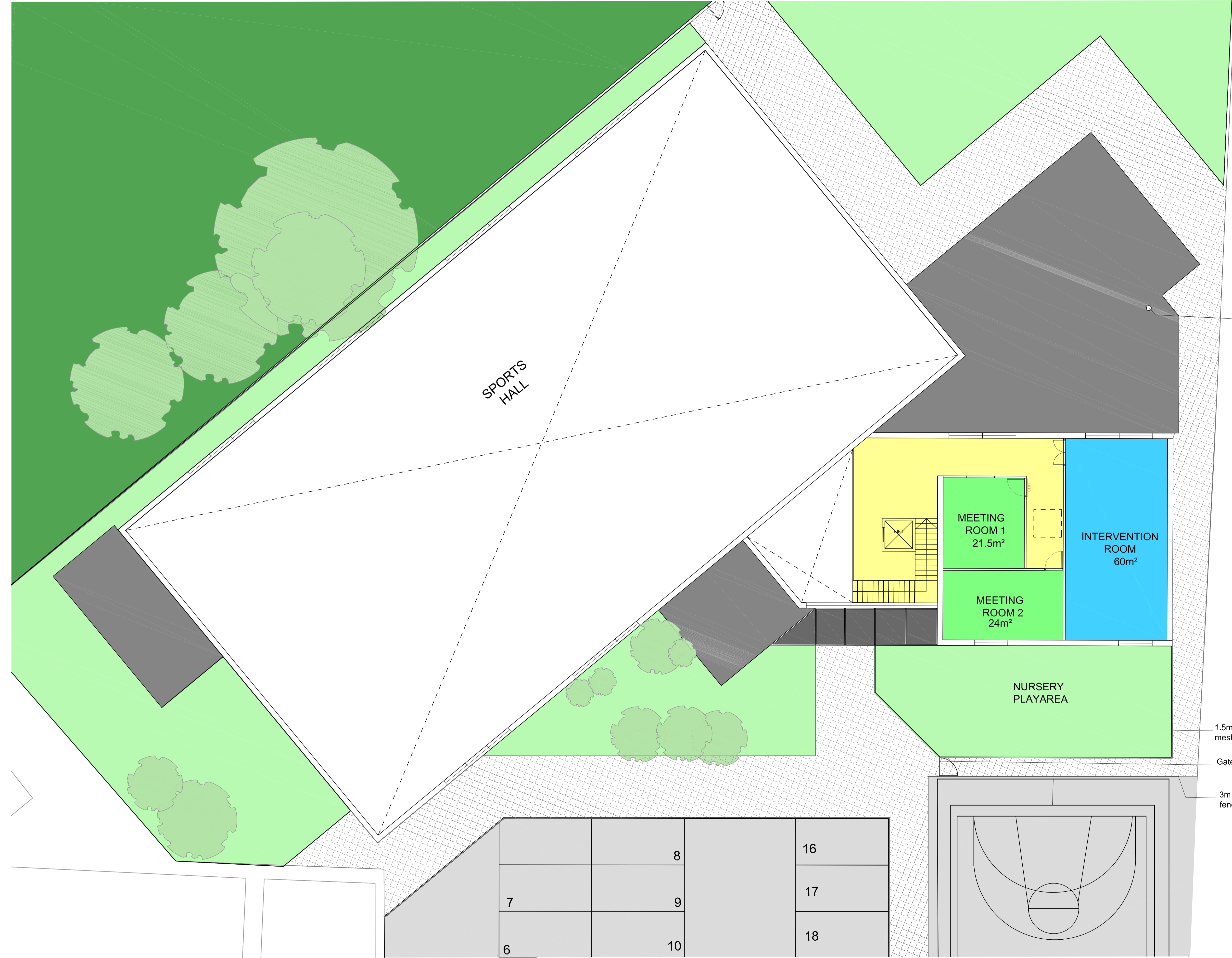

Boiler flue

1.5m weld mesh fence

Gate

3m weld mesh fence

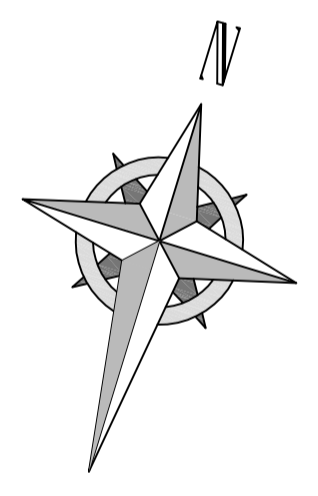

Rev	Description	Design	Drawn	Checked	Approved	Date
<p>The BTC, Bassett Drive, Stevenage, Herts SG1 2DX Tel: +44 (0) 161 3448731 Fax: (+44 (0) 1438 79105)</p>						
Client: Huntingtower Primary School						
Client Ref Number:						
Project: Huntingtower Primary School						
Site Ref \ USRN:						
Mouchel Project No:						
Drawing Title: Proposed First floor Plan Option 3						
Design: DC Drawn: SK Checked: DD Approved: DC						
Date: Dec 2015 Scale: 1:100 @: A1						
Drawing No: 4201						
Rev. No:						

0 2.5 5 7.5 10m
 Scale 1:100